



**Epic Property Consultancy Ltd.**



## Bridgewater Point Worrall Street

, Salford, M5 4YA

Asking price £220,000

This fantastic development was completed in 2018. Boasting impressive landscaped garden spaces on both lower and upper levels, situated in a ideal location and split across two blocks offering a great level of accommodation with a selection studios, one bedroom, two bedroom & three bedroom apartments available.

- Car Park Included
- EWS1 Approved
- High Specification Fixtures and Furnishings
- Modern Development with Roof Top Terrace and Landscape Garden
- Open Plan Living and Dining

### Viewing

Please contact our Epic Property Consultancy Ltd Office on 07827 130135 if you wish to arrange a viewing appointment for this property or require further information.



2



1



1



C

## Floor Plan

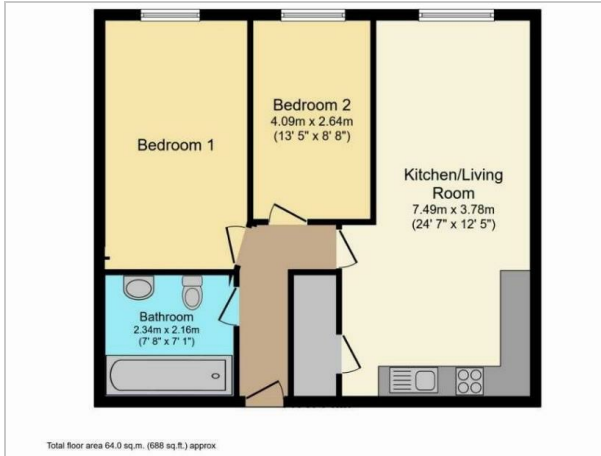

Energy Efficiency Rating		Current	Potential
Very energy efficient - lower running costs			
(92 plus) A			
(81-91) B		79	79
(69-80) C			
(55-68) D			
(39-54) E			
(21-38) F			
(1-20) G			
Not energy efficient - higher running costs			
England & Wales		EU Directive	

## Energy Efficiency Graph

## Area Map

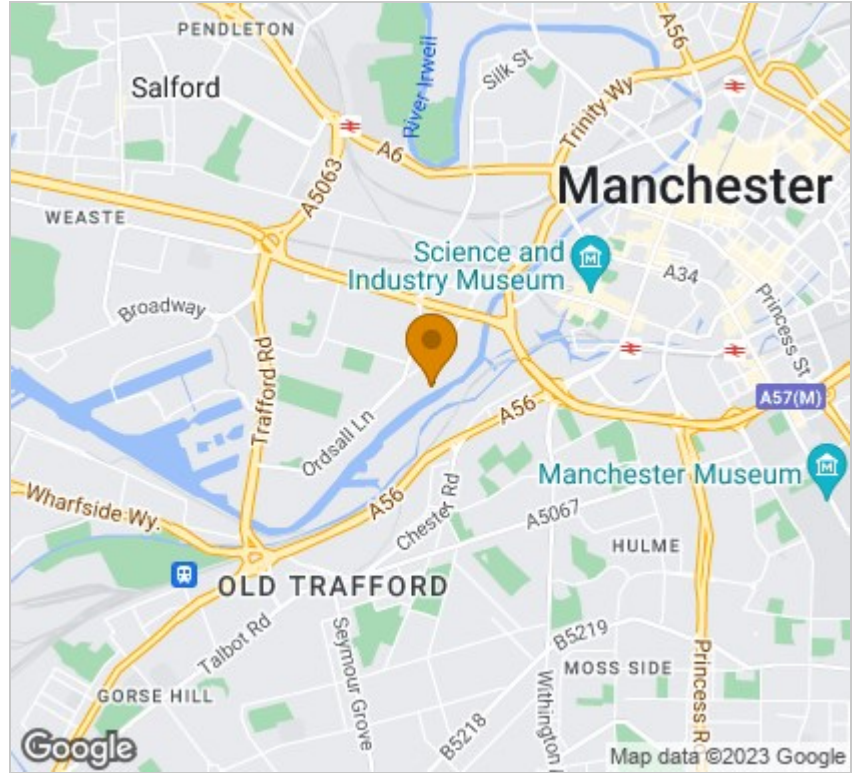

These particulars, whilst believed to be accurate are set out as a general outline only for guidance and do not constitute any part of an offer or contract. Intending purchasers should not rely on them as statements of representation of fact, but must satisfy themselves by inspection or otherwise as to their accuracy. No person in this firm's employment has the authority to make or give any representation or warranty in respect of the property.